

HIGH-SPEED LIVE CENTRES
UNIVO

For NC Lathes

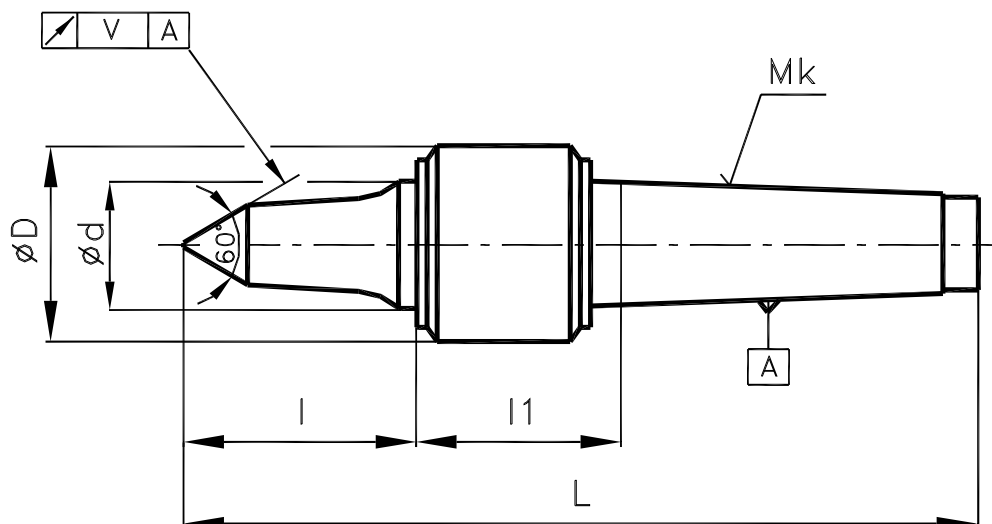

The centres are intended for the clamping of workpieces on NC lathes. Their clamping part allows for an easy access of the tool to the workpiece, which is particularly advantageous during machining of form workpieces. The live centre is provided with the shank with Morse taper according to CSN 2204208 (DIN 228, ISO296) without the clamping thread. The live centres are lubricated by lithium lubricating grease (without maintenance).

The live centres should not be disassembled.

Mk	Ø D	Ø d	L	l	l1	U	Q	G	V
4	65	30	213	43	68	9 000	600	1,85	0,005
5	82	40	261	55	77	7 000	1 200	3,75	0,005

Dimensions in mm.

Legend:

Mk ... MORSE taper

U ... max. speed [r.p.m.]

Q ... max. weight of workpiece at 50 r.p.m. and service life Lh = working hours [Kg]

G ... weight of product [kg]

V ... max. roundness deviation