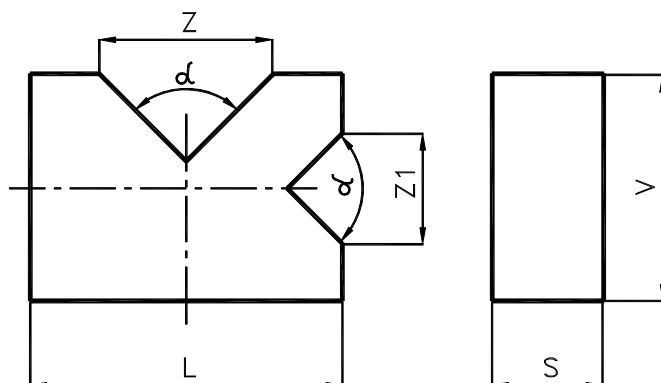

**BLOCKS WITH TWO V-CUTS**
**ČSN 25 5532**

The blocks with the tolerance of parallelity of opposite sides of 0.03/100 mm and the tolerance of the right angles according to the formula  $u = 0.02 + T/10000$ , where T = length of the long arm of angle in mm, are available. The blocks are dispatched in pairs, case-hardened to  $50 \div 55$  HRC. In a special version, blocks of dimensions at the option of the customer, including the cut angle, are available.

O	L	S	V	Z	Z1	$\alpha$	G
100	100	40	75	50	24	90	4.2
140	140	55	100	70	30		6.4
180	180	70	130	90	50		16.4

Dimensions in mm.

Legend:

O ... block marking

 $\alpha$  ... cut angle [°]

G ... weight [kg]