

**LIVE CENTRES WITH SMALL DIAMETER OF HEAD**
**24 3315**

with apex angle 60°

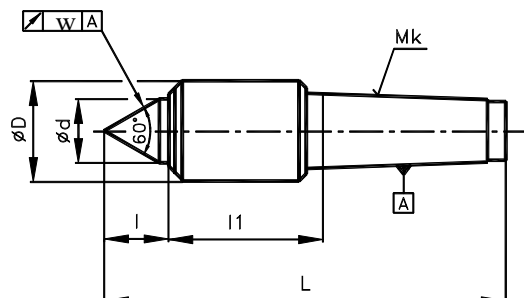

The live centers are determined for workpiece clamping in lathes, eventually for work in grinding machine. The construction of live centers features with small diameter head of tip in comparison with basic series live centers according to CSN 234423, which allows easy access tool to workpiece. Live centers are provided with the cone Morse taper according to CSN 22 04208 (DIN 228, ISO296) without the clamping thread. Protection of bearing from the ingress of coolant, dirt or swarf is provided by the built-in ring gasket which also prevent loss of lubricant, it means longer working life of live center.

The live center is lubricated by lithium grease Mogul LV2-WR. The disassembly of live center is not recommended.

Mk	$\varnothing D$	$\varnothing d$	L	l	$l_1$	n	Q	w
2	34	15	126	18	44	6 000	180	0.007
3	36	16	144	19	44	5 000	400	
4	42	20	177	24	50.5	5 000	700	
5	60	30	226	35	61,5	4 000	1 000	

Dimensions in mm

Legend:

Mk ... MORSE cone

n ... max. speed [1/min]

Q ... max. weight of workpiece [kg]

w ... max. radial run-out [mm]