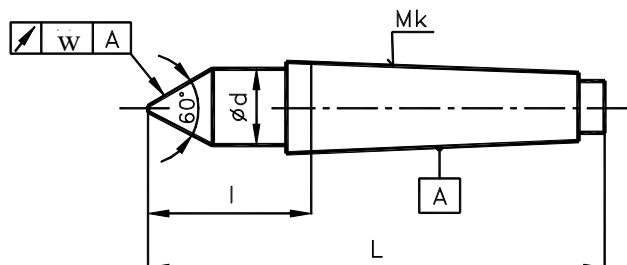

**DEAD CENTERS**
**ČSN ISO 298 (24 3310)**  
**DIN 806**

Dead centers are for clamping workpieces on machine-tools or check instruments. Dead centers of Nk=0-5 sizes are all hardened to HRC 58-62 hardness. The tip of dead center Mk=6 is hardened to the length 80 mm, the rest is heat treated. Dead centers are made from tool steel. MORSE cone shank, ČSN 220420 (DIN 228, ISO 296) is without clamping thread.

Mk	$\varnothing d$	L	l	Q	m	w
1	11	80	26.5	125	0.06	0.003
2	17	100	36	325	0.16	
3	23	125	44	650	0.40	
4	30	160	57.5	1 000	0.80	
5	42	200	70.5	2 500	1.80	
6	60	280	98	5 000	5.45	

Dimensions in mm.

Legend:

Mk.... MORSE cone

Q .... weight of workpiece [kg]

m .... weight [kg]

w .... max. radial run-out [mm]